



DCG12-17 FR

12V 17.4 AH @ 20-hr.
12V 15.8 AH @ 10-hr.

Rechargeable Sealed Lead Acid Battery
DCG Series – Deep Cycle Gel

TERMINALS: (mm)

T12: Threaded insert with
5mm stud fastener

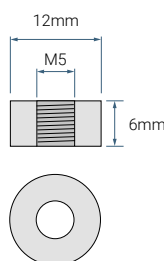

Torque: 2.0~3.0 Nxm

T12 Stocked in EU (Contact us for other terminal types)

DIMENSIONS: inch (mm)

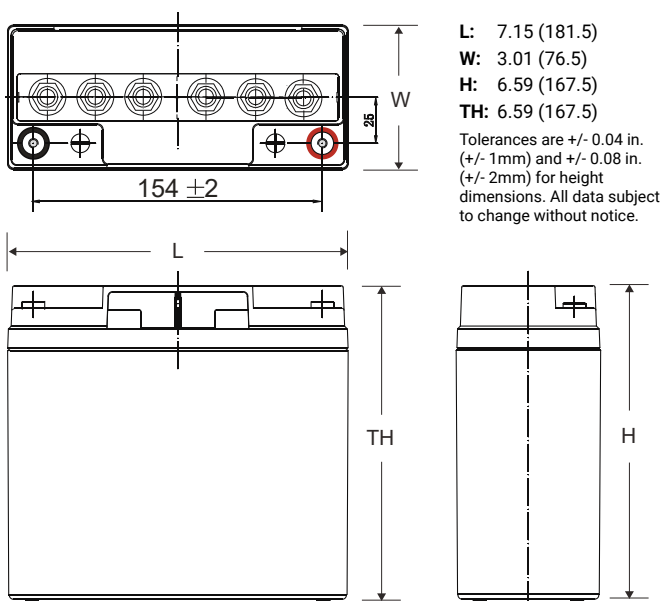

FEATURES

- Thixotropic gel electrolyte technology for superior performance
- Valve regulated, maintenance-free spill proof construction
- Power/volume ratio yielding excellent energy density
- Superb deep cycle performance and longevity in deep discharge conditions
- Rugged vibration and impact resistant ABS case and cover (UL 94 V-0)

APPROVALS

- Approved for transport by air. D.O.T., I.A.T.A., F.A.A. and C.A.B. certified
- UL 1989 Standard for Standby Batteries
- ISO9001:2015–Quality Management Systems
- IEC 60896-21/22 Stationary Lead-Acid Batteries
- EU 2023/1542 Compliant: European Battery Regulation

PERFORMANCE SPECIFICATIONS

Nominal Voltage	12 volts (6 cells)
Nominal Capacity	
20-hr. (870mA to 10.50 volts)	17.40 AH
10-hr. (1.58A to 10.50 volts)	15.80 AH
5-hr. (2.95A to 9.60 volts)	14.75 AH
1-hr. (9.93A to 9.60 volts)	9.93 AH
Approximate Weight	12.79 lbs. (5.8 kg)
Internal Resistance (approx.)	20.0 milliohms
Shelf Life (% of nominal capacity at 68°F (20°C))	
1 Month	97%
3 Month	91%
6 Month	83%
Operating Temperature Range	
Charge	-4°F (-20°C) to 104°F (40°C)
Discharge	5°F (-15°C) to 122°F (50°C)
Case	ABS Plastic Rated to UL 94 V-0
Recommended Power Sonic Chargers	PSC-124000ACX

GLOBAL HEADQUARTERS (USA AND INTERNATIONAL EXCLUDING EMEA)

The Power-Sonic Corporation
365 Cabela Dr Suite 300,
Reno, Nevada 89523
USA
T: +1 619 661 2020
E: customer-service@power-sonic.com

POWER-SONIC EMEA (EMEA – EUROPE, MIDDLE EAST AND AFRICA)

Power-Sonic EMEA
Smitspol 4, 3861 RS, Nijkerk, Netherlands
T NL: +31 33 7410 700
T UK: +44 1268 560 686
T FR: +33 344 32 18 17
E: salesEMEA@power-sonic.com

DCG12-17 FR

12V 17.4 AH @ 20-hr.
12V 15.8 AH @ 10-hr.

Rechargeable Sealed Lead Acid Battery
DCG Series – Deep Cycle Gel

CYCLE LIFE IN RELATION TO DEPTH OF DISCHARGE

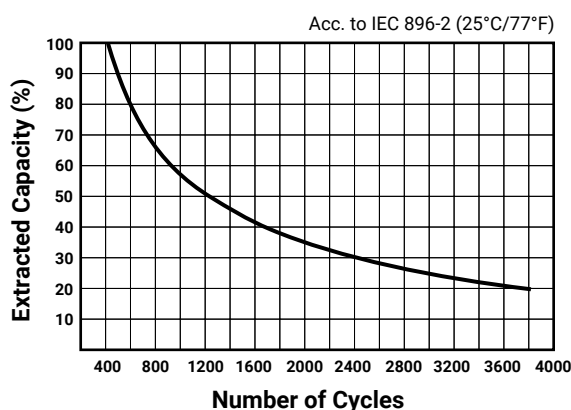

CHARGING

Cycle Applications: Apply constant voltage charge at 2.35VPC to 2.45VPC (14.1 to 14.7 volts for 12V Monobloc) at 20°C. The initial charging current should be set at less than C/5 Amps. Switch to float charge when the current falls to a 3% capacity rate to avoid overcharging.

Stand-By or "Float" Service: Apply constant voltage charge of 2.25VPC to 2.30VPC (13.5 to 13.8 volts for 12V Monobloc) at 20°C. When held at this voltage, the battery will seek its own current level and maintain itself in a fully charged condition.

Temperature Compensation: Charging voltage for both cyclic and stand-by applications should be regulated in relation to ambient temperature. As temperature rises, charging voltage should be reduced to prevent overcharge and increased as the temperature falls to avoid undercharge.

For further charging information, including temperature compensation factors, see the Power-Sonic Technical Manual.

APPLICATIONS

A whole range of CYCLIC applications including but not limited to:

- Solar
- Wind
- Mobility
- Golf Carts

GLOBAL HEADQUARTERS (USA AND INTERNATIONAL EXCLUDING EMEA)

The Power-Sonic Corporation
365 Cabela Dr Suite 300,
Reno, Nevada 89523
USA

T: +1 619 661 2020

E: customer-service@power-sonic.com

POWER-SONIC EMEA

(EMEA – EUROPE, MIDDLE EAST AND AFRICA)

Power-Sonic EMEA

Smitspol 4, 3861 RS, Nijkerk, Netherlands

T NL: +31 33 7410 700

T UK: +44 1268 560 686

T FR: +33 344 32 18 17

E: salesEMEA@power-sonic.com

GENERAL RELATION OF CAPACITY VS. STORAGE TIME

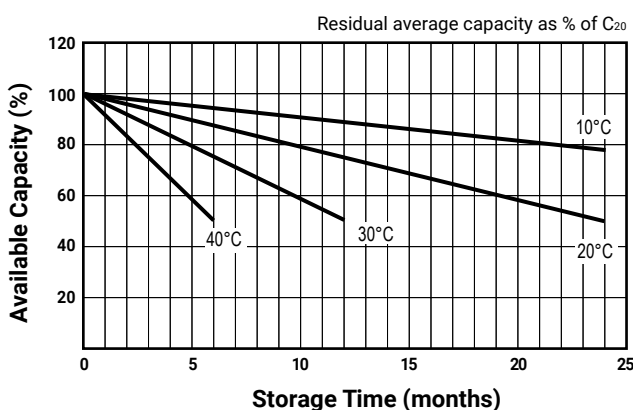

CHARGERS

Power Sonic offers a wide range of chargers suitable for batteries with a variety of capacities.

Please refer to our website for more information on our switch mode and transformer type chargers.

Please contact our technical department for advice if you have difficulty in locating a suitable charger.

FURTHER INFORMATION

Please refer to our website for a complete range of useful downloads, such as product catalogs, material safety data sheets (MSDS), ISO certification, etc.

